

**LEGEND**

- PROPOSED BASELINE
- MAIN LANES
- DRIVEWAYS
- SHOULDER LANE
- STRIPING
- PLANIMETRIC
- EMBANKMENT
- PROPOSED ROW
- EXISTING ROW
- CITY LIMITS
- ACCESS ROAD
- PROPERTY LINES
- EASEMENT
- PROPOSED LANE DIRECTIONAL INDICATOR
- RETAINING WALL
- RIP RAP

**EXHIBIT E**  
**DESIGN SCHEMATIC**

SHEET 1 OF 5  
BU 900: FROM IH 610 TO EAST OF MESA ROAD  
HARRIS COUNTY, TEXAS



SCALE: 0' 50' 100'  
HORIZONTAL 1" = 100'

MATCH LINE  
STATION 116+00

MATCH LINE  
STATION 116+00

**LEGEND**

- PROPOSED BASELINE
- MAIN LANES
- DRIVEWAYS
- SHOULDER LANE
- STRIPING
- PLANIMETRIC
- EMBANKMENT
- PROPOSED ROW
- EXISTING ROW
- CITY LIMITS
- ACCESS ROAD
- PROPERTY LINES
- EASEMENT
- PROPOSED LANE DIRECTIONAL INDICATOR
- RETAINING WALL
- RIP RAP

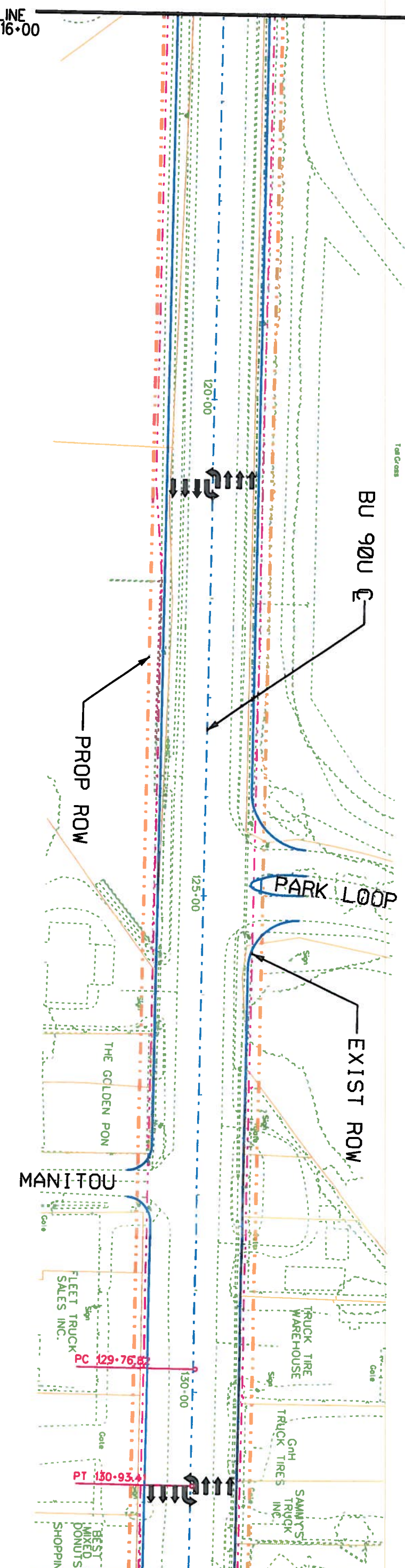

MATCH LINE  
STATION 132+00

MATCH LINE  
STATION 132+00

**EXHIBIT E**

**DESIGN SCHEMATIC**

SHEET 2 OF 5

BU 90 FROM IH 610 TO EAST OF MESA ROAD  
HARRIS COUNTY, TEXAS



SCALE: 0' 50' 100'

HORIZONTAL 1" = 100'



MATCH LINE  
STATION 132+00

MATCH LINE  
STATION 132+00

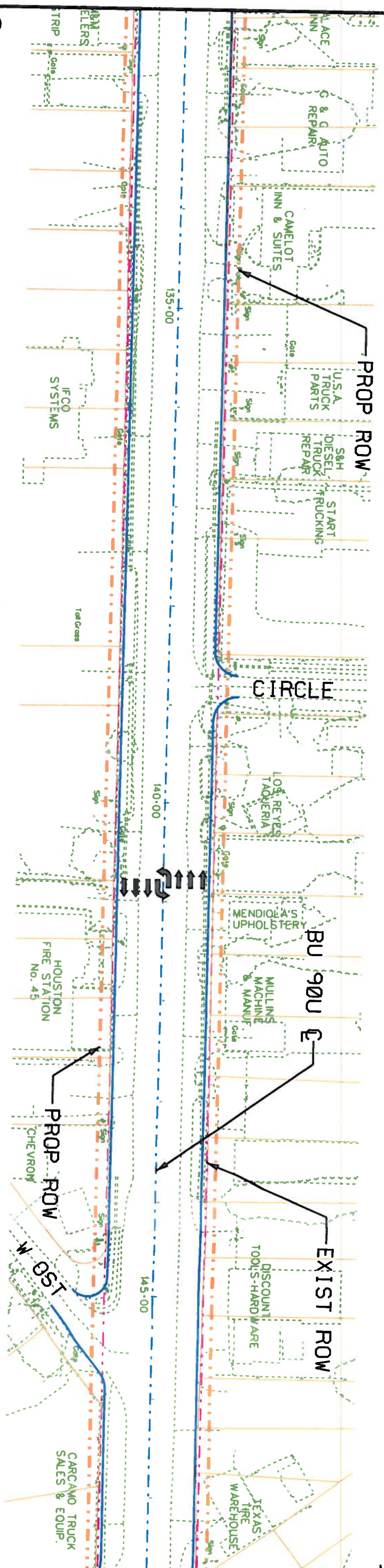

MATCH LINE  
STATION 147+75

MATCH LINE  
STATION 147+75

**LEGEND**

- PROPOSED BASELINE
- MAIN LANES
- DRIVEWAYS
- SHOULDER LANE
- STRIPING
- PLANIMETRIC EMBANKMENT
- PROPOSED ROW
- EXISTING ROW
- CITY LIMITS
- ACCESS ROAD
- PROPERTY LINES
- EASEMENT
- PROPOSED LANE DIRECTIONAL INDICATOR
- RETAINING WALL
- RIP RAP

**EXHIBIT E  
DESIGN SCHEMATIC**

BU 900 FROM IH 610 TO EAST OF MESA ROAD  
HARRIS COUNTY, TEXAS

SHEET 3 OF 5



SCALE: 8' = 1" (Vertical)  
100' = 1" (Horizontal)

MATCH LINE  
STATION 147+75

MATCH LINE  
STATION 147+75

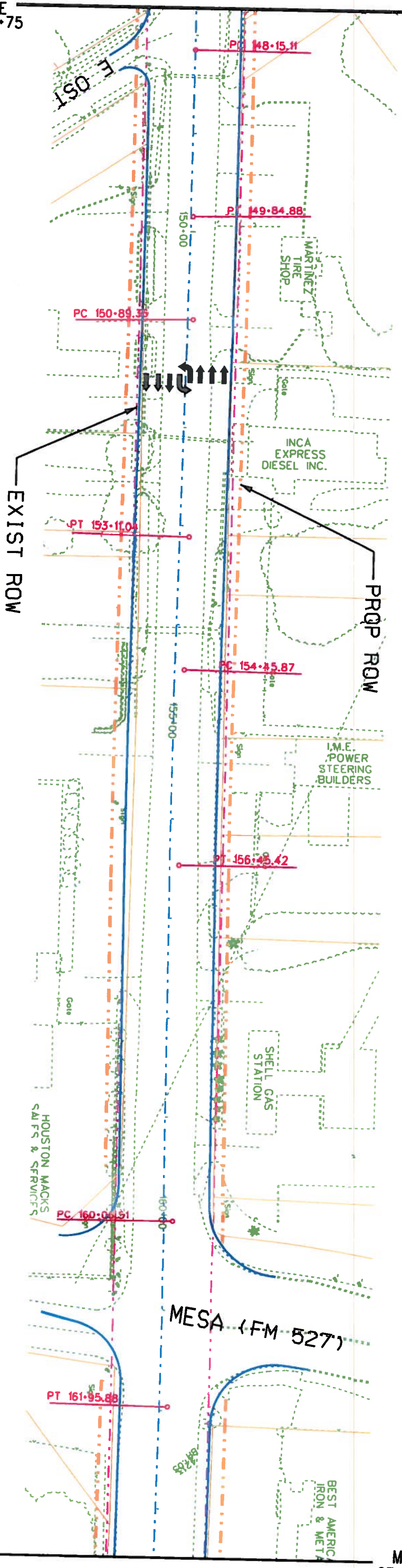

MATCH LINE  
STATION 163+50

MATCH LINE  
STATION 163+50

**LEGEND**

- PROPOSED BASELINE
- MAIN LANES
- DRIVEWAYS
- SHOULDER LANE
- STRIPING
- PLANIMETRIC EMBANKMENT
- PROPOSED ROW
- EXISTING ROW
- CITY LIMITS
- ACCESS ROAD
- PROPERTY LINES
- EASEMENT
- PROPOSED LANE DIRECTIONAL INDICATOR
- RETAINING WALL
- RIP RAP

**EXHIBIT E  
DESIGN SCHEMATIC**

SHEET 4 OF 5

BU 90, FROM IH 610 TO EAST OF MESA ROAD  
HARRIS COUNTY, TEXAS



SCALE: 0' 50' 100'  
HORIZONTAL 1" = 100'



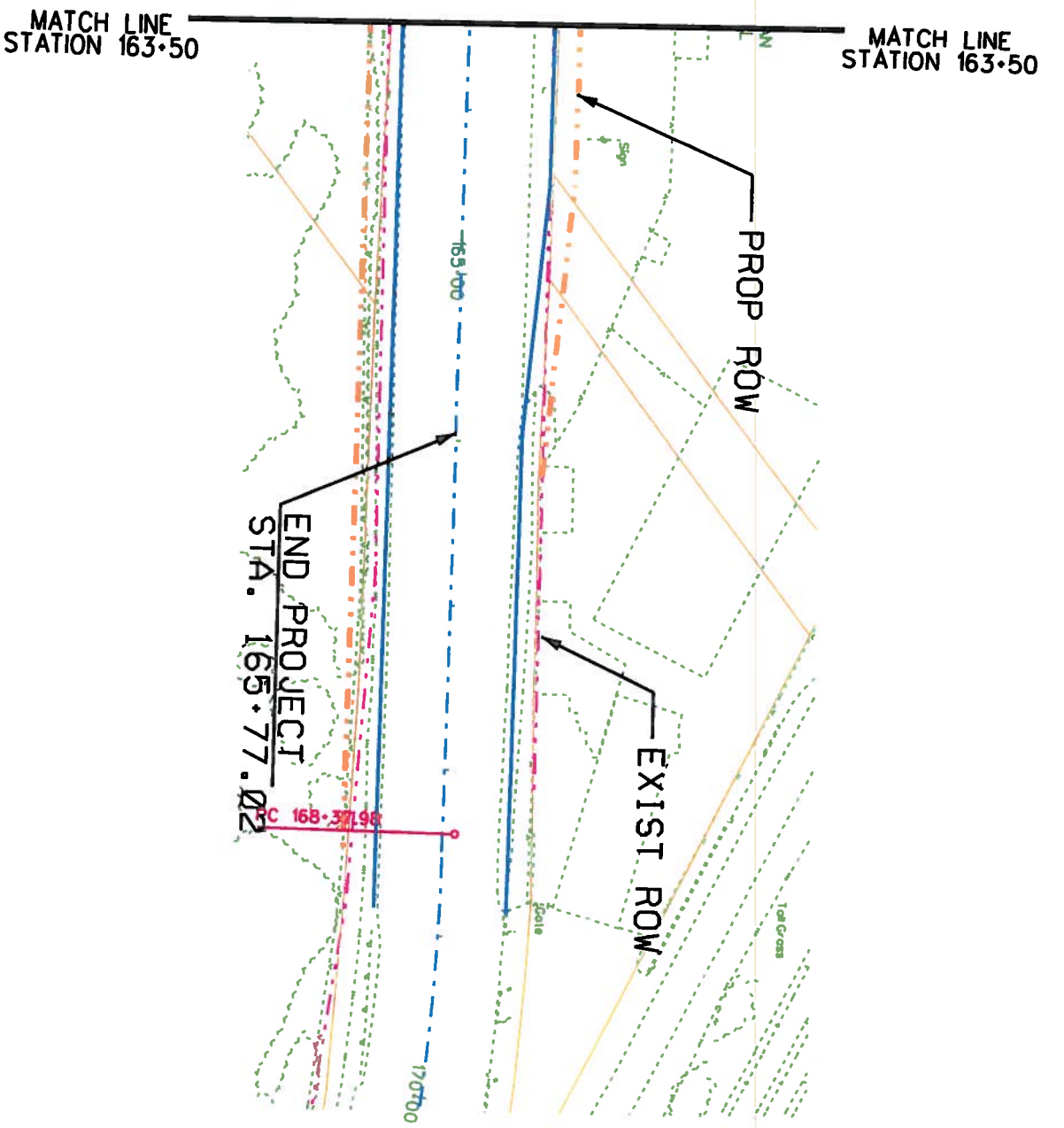

**LEGEND**

- PROPOSED BASELINE
- MAIN LANES
- DRIVERWAYS
- SHOULDER LANE
- STRIPING
- PLANIMETRIC
- EMBANKMENT
- PROPOSED ROW
- EXISTING ROW
- CITY LIMITS
- ACCESS ROAD
- PROPERTY LINES
- EASEMENT
- PROPOSED LANE DIRECTIONAL INDICATOR
- RETAINING WALL
- RIP RAP

**EXHIBIT E**  
**DESIGN SCHEMATIC**  
SHEET 5 OF 5

BU 90, FROM IH 610 TO EAST OF MESA ROAD  
HARRIS COUNTY, TEXAS

SCALE: 8" = 50'  
HORIZONTAL 1" = 100'

PROJECT NO.	NH ( )		SHEET NO.	1
STATE DIST.	6	TX	HARRIS	
COUNTY	HARRIS		HIGHWAY NO.	BU 90U
CONTRACT NO.	0028 01	067	SECTION	067

**STATE OF TEXAS**  
**DEPARTMENT OF TRANSPORTATION**  
**PLANS OF PROPOSED**  
**STATE HIGHWAY IMPROVEMENT**

**90% SUBMITTAL**

SEE SHEET 2 FOR INDEX OF SHEETS

**TDLR INSPECTION REQUIRED**

LIMITS: FROM IH 610 NORTHEAST TO EAST OF MESA RD  
HARRIS COUNTY

FOR THE CONSTRUCTION OF WIDENING OF A NON-FREEWAY FACILITY  
CONSISTING OF GRADING, BASE CONCRETE PAVEMENT, CEMENT TREATED BASE,  
LIME TREATED SUB-GRADE, STORM SEWER, CITY OF HOUSTON WATER MAIN,  
CITY OF HOUSTON SANITARY SEWER, TRAFFIC SIGNAL, SIGNING,  
PAVEMENT MARKINGS, AND SW3P.

ROADWAY & STORM PIPE LENGTH = 7,099.15 FT = 1.344 MI  
BRIDGE LENGTH = 0.00 FT = 0.000 MI  
TOTAL LENGTH OF PROJECT = 7,400.00 FT = 1.402 MI

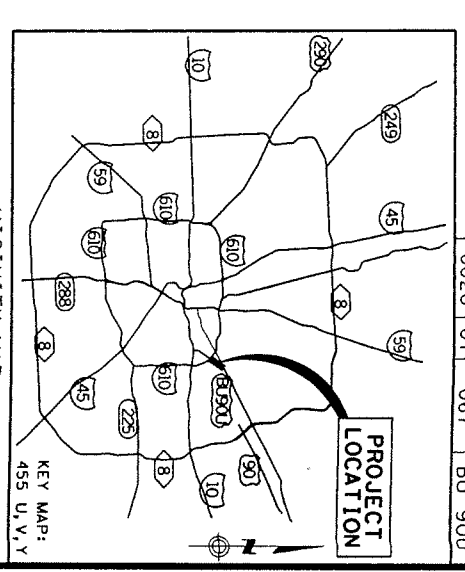

**FINAL PLANS**  
DATE CONTRACTOR BEGAN WORK: \_\_\_\_\_  
DATE WORK COMPLETED: \_\_\_\_\_  
DATE WORK ACCEPTED: \_\_\_\_\_  
CONTRACTOR NAME: \_\_\_\_\_

CONSTRUCTION WORK ON THIS PROJECT WAS  
PERFORMED IN ACCORDANCE WITH THE PLANS,  
CONTRACT, AND APPROVED CHANGE ORDERS.

P. E. \_\_\_\_\_  
DATE \_\_\_\_\_

1. ALL COORDINATES ARE BASED ON THE TEXAS STATE PLANE COORDINATE SYSTEM, SOUTH CENTRAL ZONE NAD 83 (1993 ADJ.). ALL COORDINATES AND DISTANCES SHOWN HEREON ARE SURFACE AND MAY BE CONVERTED TO GRID BY DIVIDING BY A TXDOT COMBINED ADJUSTMENT FACTOR OF 1.00013.
2. CONTROL POINTS H-1 THROUGH H-7 ARE EXISTING MONUMENTS FURNISHED BY TXDOT FROM A PREVIOUS SURVEY PERFORMED BY CIVIL CONCEPTS, INC. IN SEPTEMBER 2003.
3. COORDINATE VALUES FOR H-1, H-2, H-3, H-4, H-5, H-6, AND H-7, ARE THE PUBLISHED VALUES PROVIDED BY TXDOT. THE COORDINATE VALUES FOR CLR-11 THROUGH CLR-18 ARE BASED ON THE SURVEY PERFORMED BY CLR, INC.
4. ALL ELEVATIONS SHOWN HEREON ARE BASED ON NAVD 88 (1996 ADJ.). ELEVATION VALUES FOR CONTROL POINTS H-1 THROUGH H-7 WERE VERIFIED BY DIFFERENTIAL THREE WIRE LEVEL LOOPS, AND BASED ON THE PUBLISHED ELEVATIONS FOR TXDOT CONTROL POINTS H-2 AND H-7.
5. ATTACHMENT NO. 01-09 TO SPECIAL AGREEMENT FOR CONSTRUCTION MAINTENANCE AND OPERATION OF STREET ILLUMINATION SYSTEM WITHIN MUNICIPALITY, DATED JUNE 5, 1963. THE CITY-STATE CONSTRUCTION MAINTENANCE AND OPERATION RESPONSIBILITIES SHALL BE AS HERETOFORE AGREED TO, ACCEPTED AND SPECIFIED IN THE AGREEMENT TO WHICH THESE PLANS ARE MADE A PART.

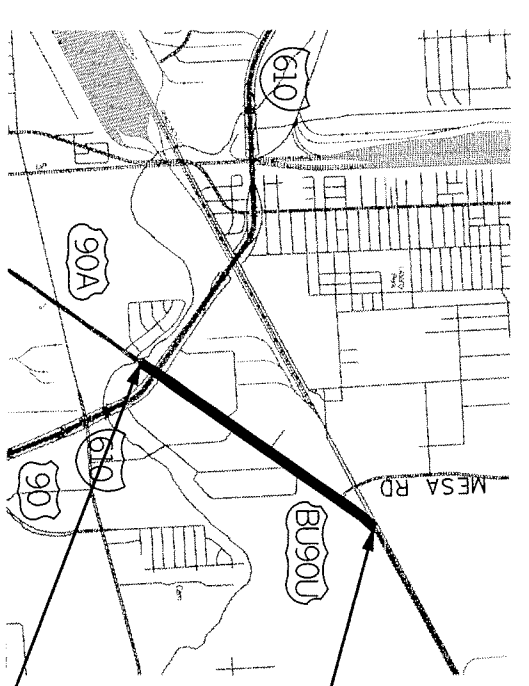

**END PROJECT**  
CSJ 0028-01-067  
BU 90U STA 170+00.00  
X = 3,155,131.29  
Y = 13,863,411.64  
RM =

**BEGIN PROJECT**  
CSJ 0028-01-067  
BU 90U STA 96+00.00  
X = 3,150,767.04  
Y = 13,857,313.73  
RM =

CITY OF HOUSTON	
WATER	CONSTRUCTION
WASTEWATER	SPONSOR DEPARTMENT
CITY ENGINEER	DATE
DIRECTOR OF PUBLIC WORKS AND ENGINEERING	DATE

EXCEPTIONS: NONE  
EQUATIONS: NONE  
RAILROAD CROSSING: NONE

**TEXAS DEPARTMENT OF TRANSPORTATION**  
© 2010 by Texas Department of Transportation

SUBMITTED FOR LETTING: \_\_\_\_\_

PROJECT MANAGER: \_\_\_\_\_

RECOMMENDED FOR LETTING: \_\_\_\_\_

DISTRICT ENGINEER: \_\_\_\_\_

APPROVED FOR LETTING: \_\_\_\_\_

DIRECTOR, DESIGN DIVISION: \_\_\_\_\_

APPROVED FOR LETTING: \_\_\_\_\_

DIRECTOR, TRAFFIC OPERATIONS DIVISION: \_\_\_\_\_

**CLR, Inc.**  
**Engineers • Surveyors • GIS**  
TX REGISTRATION NO. 275  
(713) 462-0993

COUNTY HARRIS PROJ. NO. NH ( )  
HWY. NO. BU 90U LETTING DATE NOVEMBER 2011  
DATE ACCEPTED \_\_\_\_\_

SPECIFICATIONS ADOPTED BY THE TEXAS DEPARTMENT OF TRANSPORTATION, JUNE 1, 2004 AND SPECIFICATION ITEMS LISTED AND DATED AS FOLLOWS, SHALL GOVERN ON THIS PROJECT: REQUIRED CONTRACT PROVISIONS FOR ALL FEDERAL-AID CONSTRUCTION CONTRACTS (FORM FHWA 1273, MARCH, 1994).

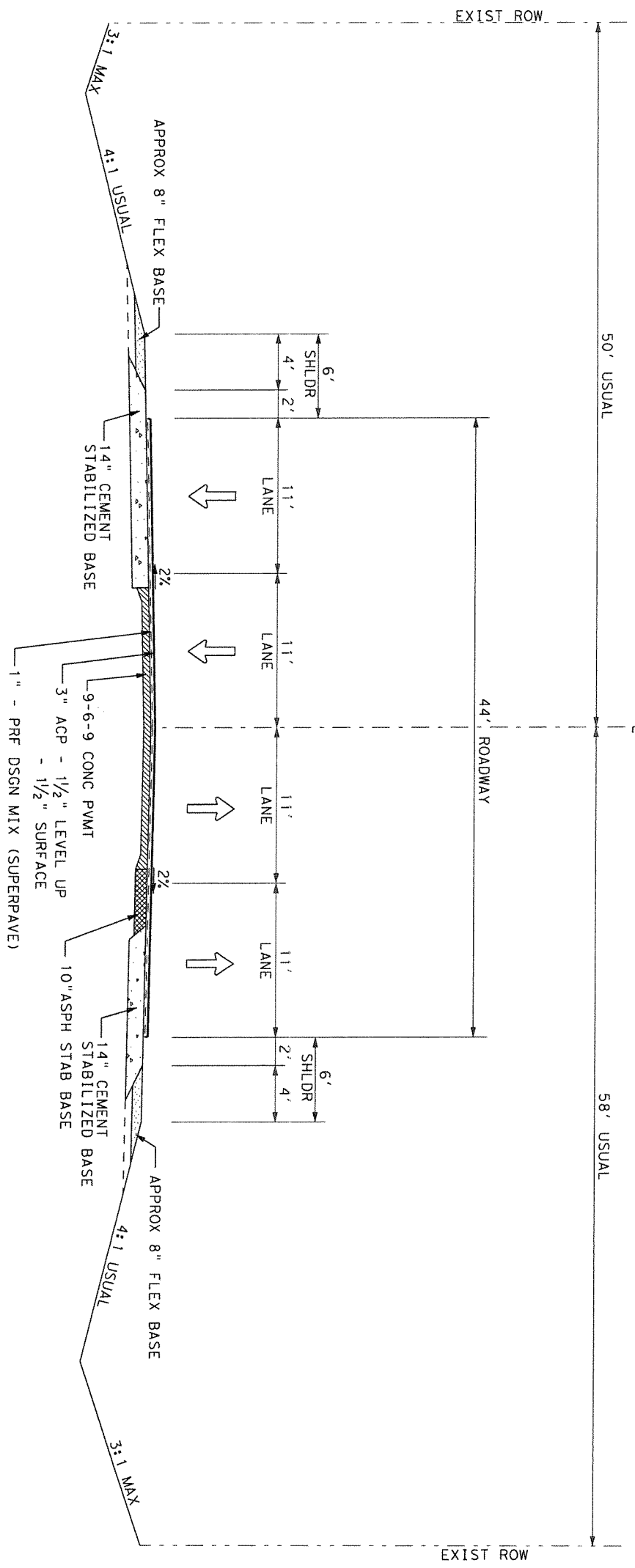

EXIST TYPICAL SECTION  
 STA 104+65 to STA 166+00

90% SUBMITTAL

INTERIM SUBMITTAL  
 DOCUMENT INCOMPLETE, NOT  
 INTENDED FOR PERMITS,  
 BIDDING OR CONSTRUCTION.  
 ENGINEER:  
 KYLE A. BERTRANO, P.E.  
 REGISTRATION NO. 84575  
 DATE: 08/28/10



TX REGISTRATION NO. 275  
**CLR, Inc.** (713) 462-0993  
 Engineers • Surveyors • GIS  
 ©2010  
 Texas Department of Transportation

EXISTING  
 TYPICAL SECTION

SHEET 1 OF 1		SHEET NO. 5	
FED. RD. DIV. NO. 6	PROJECT NO.	STATE	COUNTY
TEXAS	HOU	HARRIS	
0028	01	067	BU 90U

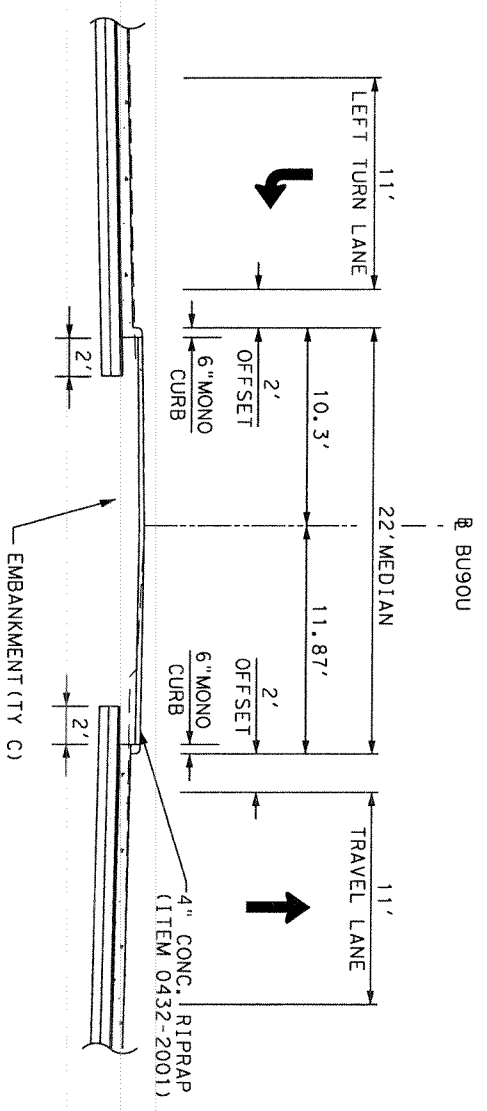
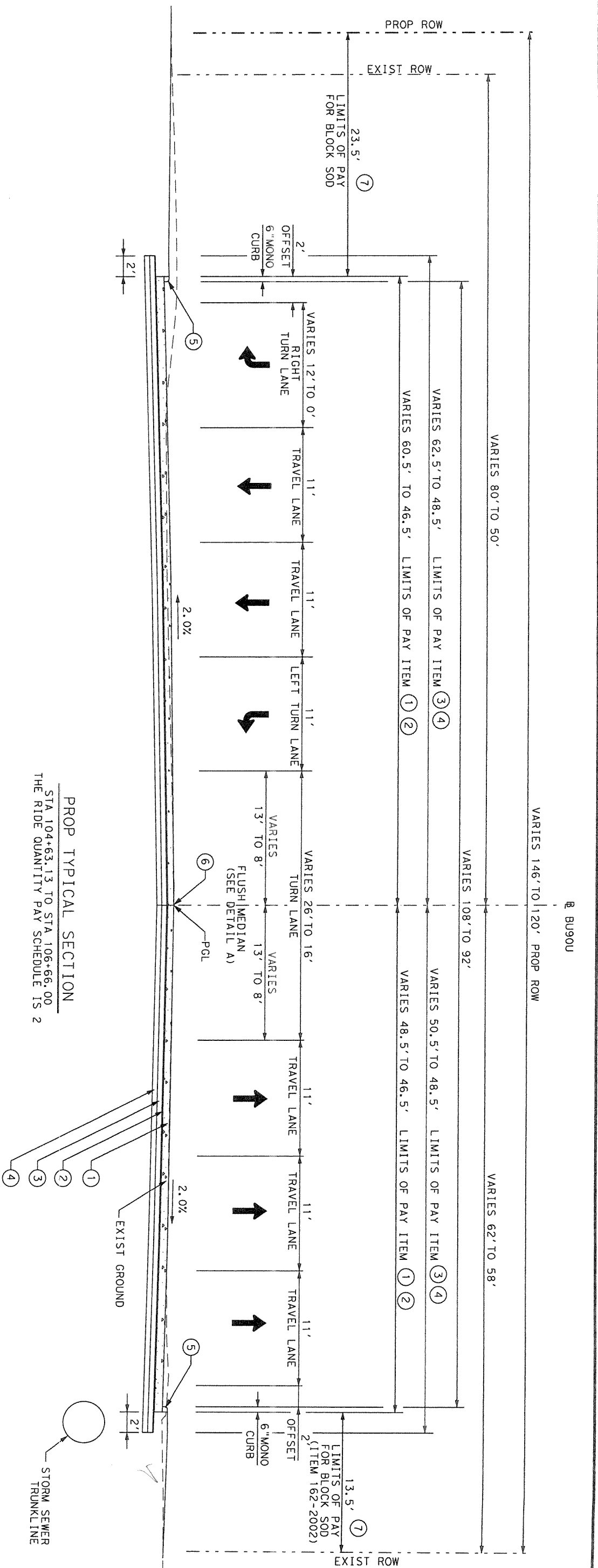

**90% SUBMITTAL**

INTERIM SUBMITTAL  
 DOCUMENT INCOMPLETE, NOT  
 INTENDED FOR PERMITS,  
 BIDDING OR CONSTRUCTION.

ENGINEER:  
 KYLE A. BERTRAND  
 P.E. REGISTRATION NO. 184575  
 DATE: 08/28/10

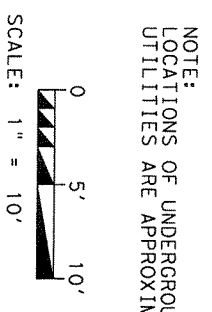

NOTE:  
 LOCATIONS OF UNDERGROUND  
 UTILITIES ARE APPROXIMATE.

TX REGISTRATION NO. 275  
**CLR, Inc.** (713) 462-0993  
 Engineers • Surveyors • GIS

©2010  
 Texas Department of Transportation  
**BU 90 U**

PROPOSED  
 TYPICAL SECTION

FED. RD. DIST. NO.	PROJECT NO.	SHEET NO.
6		5
STATE	DIST.	COUNTY
TEXAS	HOU	HARRIS
CONTRACT NO.	JOB NO.	ROUTE NO.
0028	01 067	BU 90U

SHEET 1 OF 2



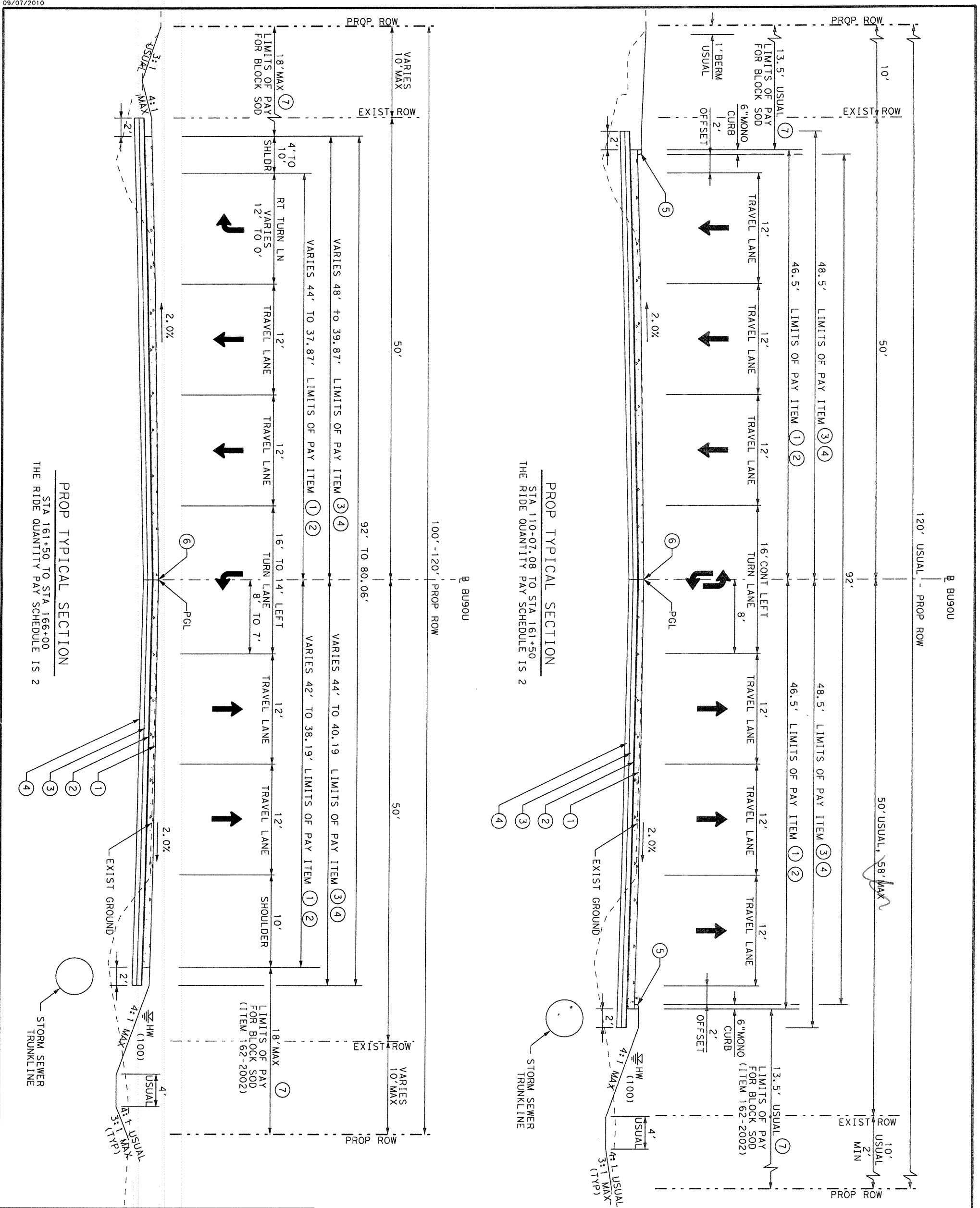

**LEGEND:**

- ① 12" CRCP (0360-2005)
- ② 1" ASB (0292-2007)
- ③ 6" CTB (0276-2224)
- ④ 6" LTS (0260-2014)
- ⑤ 6" MONO CURB (0529-2006)
- ⑥ LONGITUDINAL DOWEL JOINT
- ⑦ LIMITS OF PAY FOR BLOCK SOD
- ➔ DIRECTION OF PROPOSED TRAFFIC
- ➞ DIRECTION OF EXISTING TRAFFIC

NOTE:  
 LOCATIONS OF UNDERGROUND UTILITIES ARE APPROXIMATE.

**90% SUBMITTAL**

INTERIM SUBMITTAL  
 DOCUMENT INCOMPLETE; NOT INTENDED FOR PERMITS, BIDDING OR CONSTRUCTION.  
 ENGINEER:  
 KYLE A. BERTRAND, P.E.  
 REGISTRATION NO.: 84575  
 DATE: 08/28/10



**CLR, Inc. (713) 462-0993**  
 Engineers • Surveyors • GIS

Texas Department of Transportation  
 BU 90 U

PROPOSED  
 TYPICAL SECTION

TX REGISTRATION NO. 275  
 @2010

FED. NO.	PROJECT NO.	SHEET NO.
DIV. NO.		
6		7
STATE	DIST.	COUNTY
TEXAS	HOU	HARRIS
COMT.	SECT.	HIGHWAY NO.
0028	01	067 BU 90U

SHEET 2 OF 2